



Info Session

TOHOKU & KYUSHU UNIVERSITY

Summer Internship 2025

Japan Imperial Universities



<https://en.namu.wiki/w/%EC%A0%9C%EA%B5%AD%EB%8C%80%ED%95%99>



KYUSHU
UNIVERSITY



Where is Kyushu University?

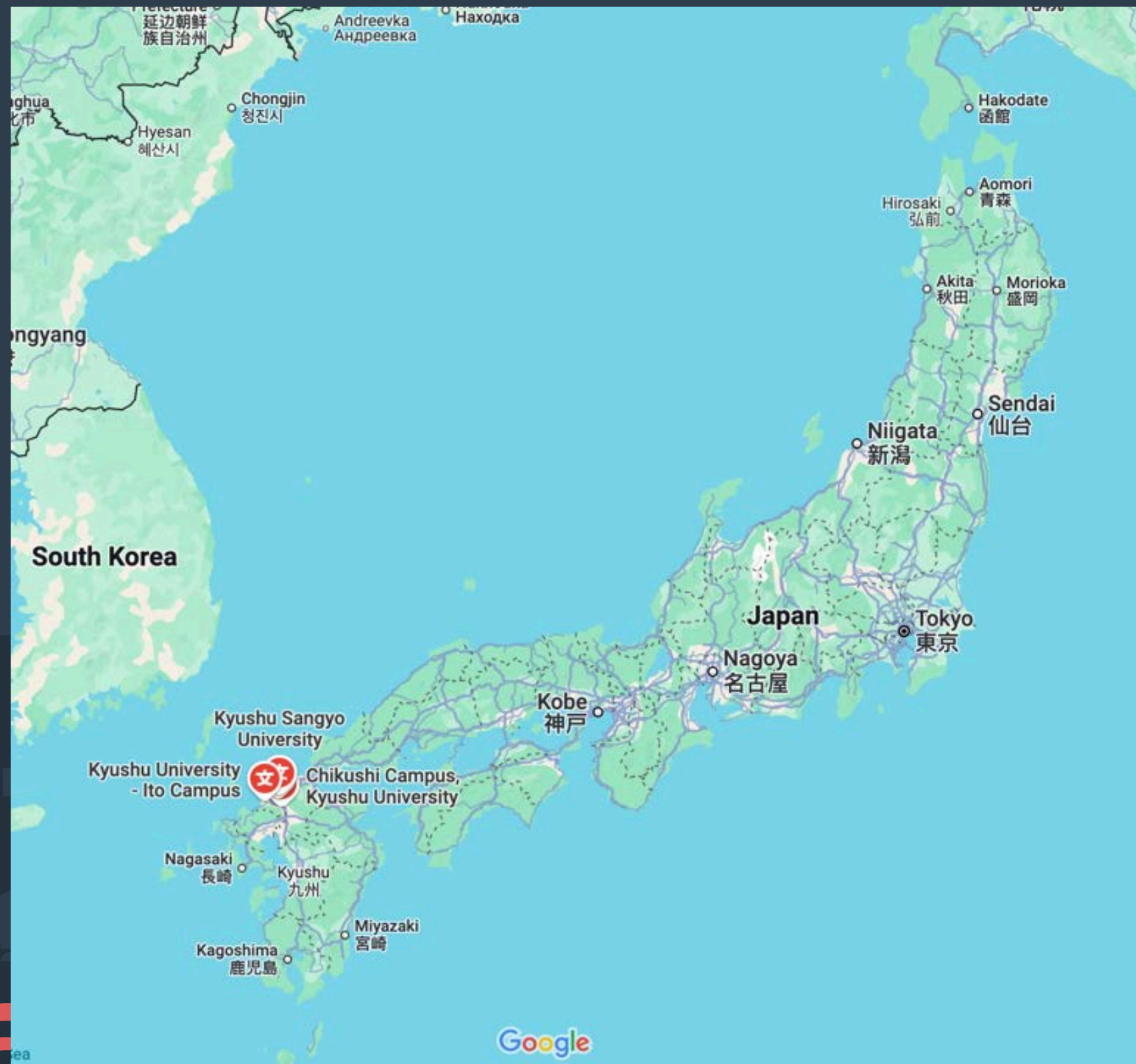

POSL Research Group

- Principles of Software engineering and programming Languages (POSL)



More Information: <https://posl.ait.kyushu-u.ac.jp/en>

POSL Professors

1. SE for AI, AI for SE

- Machine Learning Engineering
- Automatic Improvement of Neural Network Models
- Co-creative Programming with AI
- Formal Verification

2. Mining Software Repositories

- Open Source Software Engineering
- Empirical Software Engineering
- Software Test/Debug
- Automated Refactoring

Prof. Yasutaka Kamei



Asst. Prof. Masanari Kondo 6

More Information: <https://posl.ait.kyushu-u.ac.jp/en>

Eligibility Criteria

Number of acceptances: 2-3 students

Requirement: CGPA \geq 3.00 (strong programming skills)

Duration: 12 weeks (19 May-11 August 2025)

Support:

- Can apply for Mahidol Student Mobility Scholarship (75,000 THB)
- Accommodation: May get student dormitory
- Flight ticket: ~20,000 THB
- Food: ~40,000 Yen/month/person (~ 13,000 THB*3 months)
- Contact Point: Aj. Thanwadee, Aj. Morakot, Aj. Chaiyong, Aj. Pattaraporn

Life in Fukuoka



Life in Fukuoka

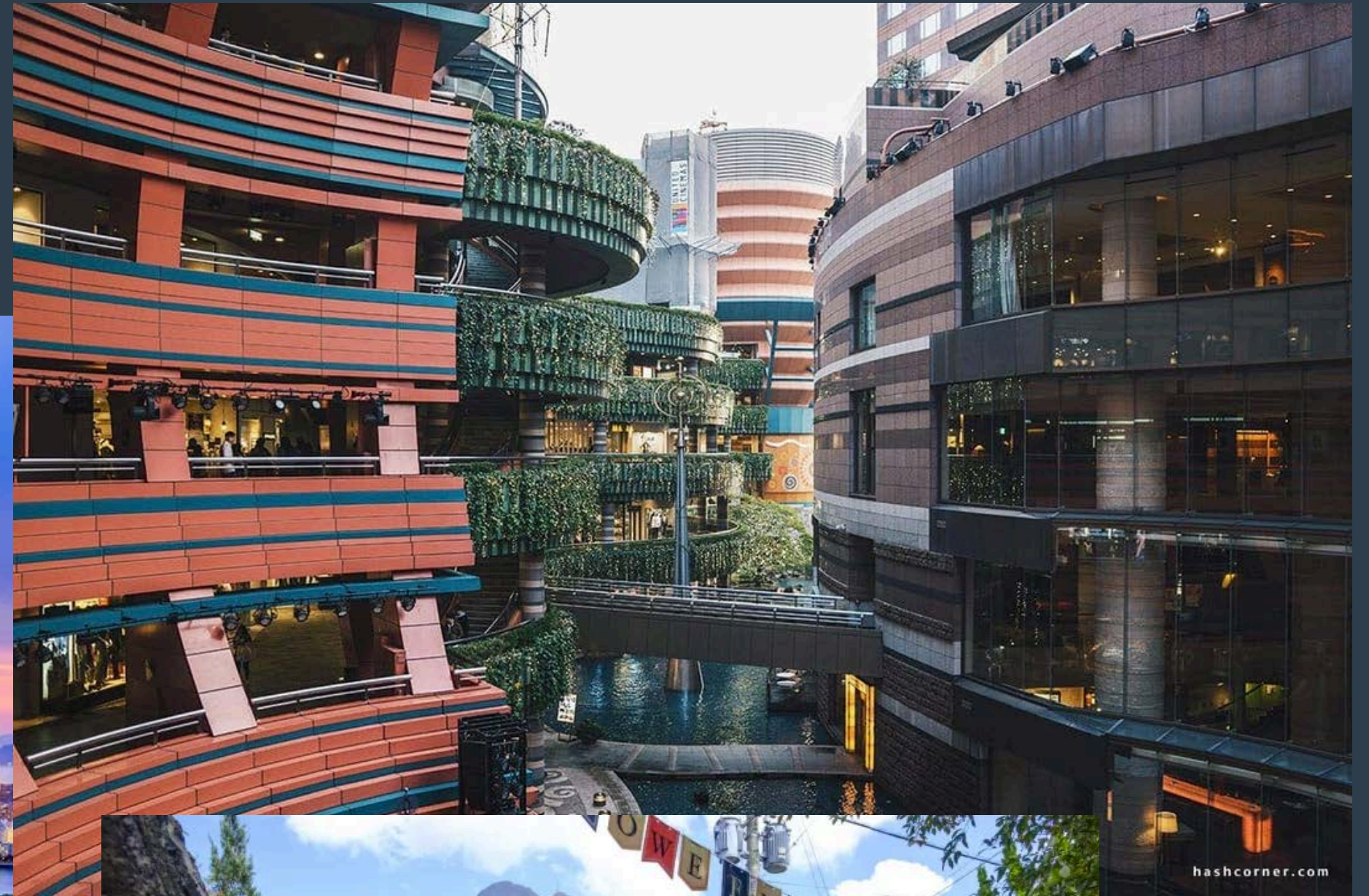



TOHOKU
UNIVERSITY



Where is Tohoku University?

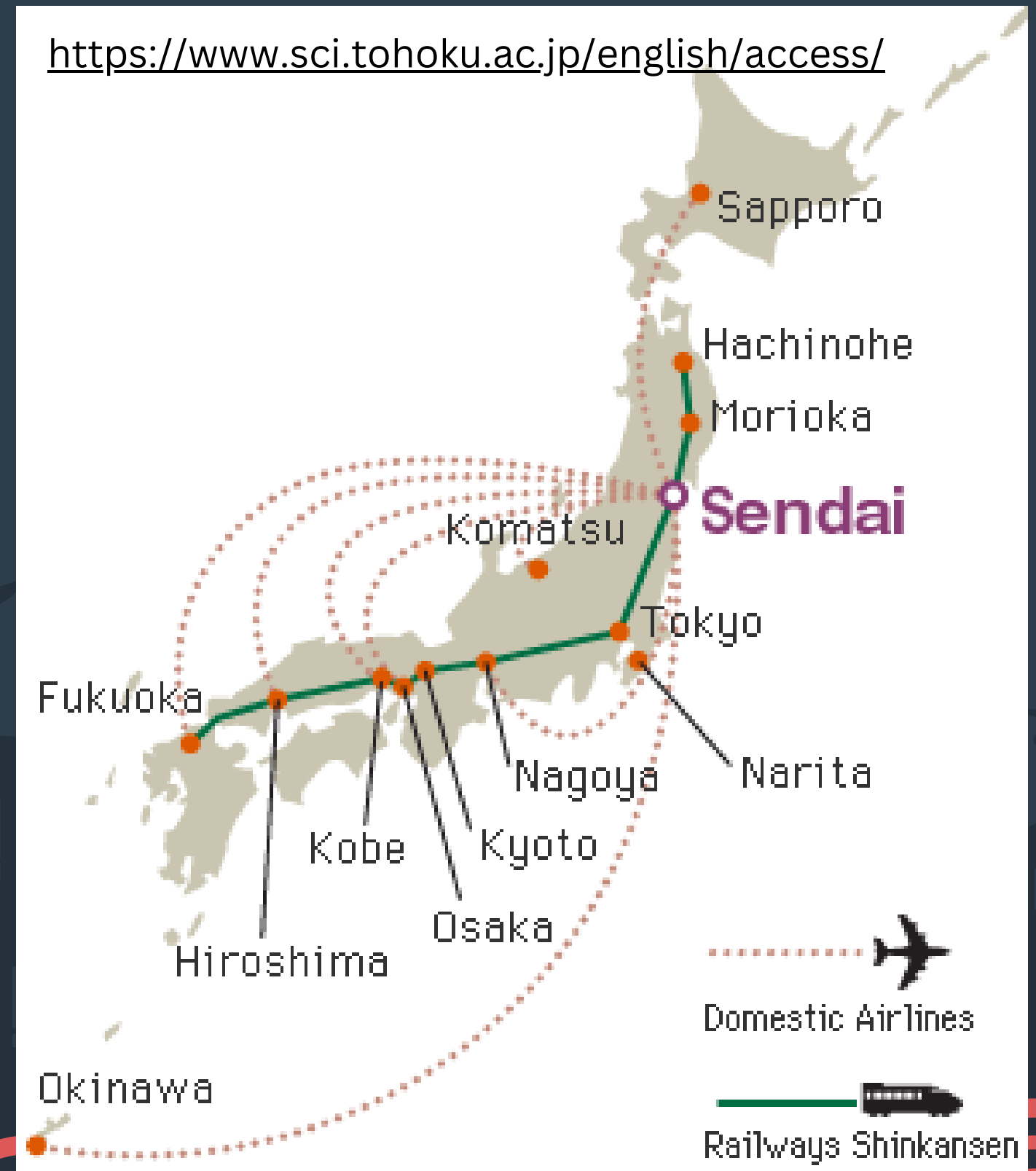
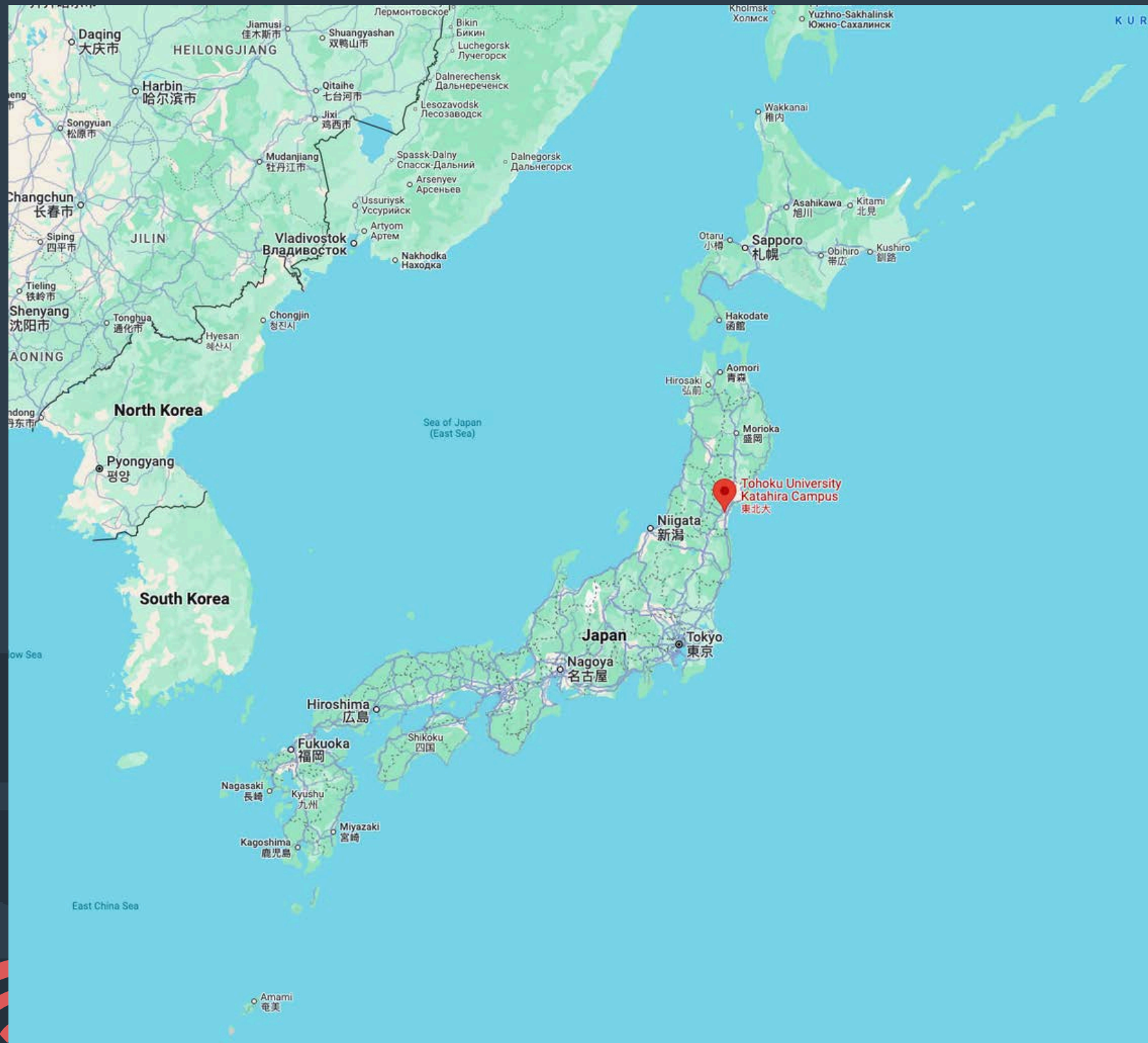

Where is Tohoku University?



Location

- In north-eastern Japan
- Distance from Tokyo (\approx 350 km)
- Travel time from Tokyo (\approx 1hr 35mins)
** by a bullet train



Population of Sendai City

- 1.098 million (as of Aug 1, 2023)

Founded in 1907 as the 3rd Imperial University of Japan

More Information: <https://www.tohoku.ac.jp/en/>



Tohoku: No. 1 University in Japan



[International Affairs](#) [Students](#) [Current Students](#) [Alumni](#) [Faculty/Staff](#)



TOHOKU UNIVERSITY
CREATING GLOBAL EXCELLENCE

TOHOKU
UNIVERSITY

[About](#) [Academics](#) [Admissions](#) [Research](#) [Campus Life](#) [News](#) [Events](#)

[Home](#) > [News](#) > [University News](#) > [Tohoku University Ranked N](#)

News



Tohoku University Ranked Number One in Japan for Fourth Consecutive Year

2023-03-23 | [University News](#)

Tohoku University tops Times Higher Education's Japan University Rankings for the fourth year in a row

Times Higher Education launches the Japan University Rankings 2023 today
March 23, 2023

Times Higher Education (THE) has launched the Japan University Rankings (JUR) 2023 today, with Benesse Group for innovation and globalization of universities in Japan.

Tohoku University was ranked top for the fourth year in a row and the University of Tokyo was ranked second again, which it attained last year. Osaka University was ranked third (joint third last year), and Tokyo Institute of Technology is fourth (joint third last year). This is followed by Kyoto University in fifth place (fifth last year) and Kyushu University is in sixth position climbing up one place from seventh last year. International Christian University is in the top ten for the first time this year.



ReaLearn Research Group



Affiliation

- Founded in October 3, 2022, affiliating with School of IS, JAIST
- Expected to be affiliated with Tohoku University from April 1, 2025

Research Focus

- Basically, anything about Trustworthy AI, ensuring it is safe for humans
- By a joint collaboration with SERU@MUICT, we are currently paying our attention on how to develop reliable and explainable SE solutions.

Dr. Teeradaj Racharak (Aj. X)

- Senior Lecturer (to-be Associate Professor at Tohoku)
- Dr. Racharak is broadly interested in mathematical modeling and implementation of AI.
- He specializes in logic and machine learning, particularly in Description Logic, Computational Argumentation, and Deep Learning.
- He has a diverse educational background and work experience in universities and software industries.



More Information: <https://www.jaist.ac.jp/~racharak/lab>

Internship Research Topics



1. SE4AI: Investigating on adopting SE principles for AI development
2. LLM4XSE: Investigating on the design and development of explainable SE-related tasks using LLMs.
3. Mechanistic Interpretability for AI-based Software Development
(Related Paper: <https://openreview.net/pdf?id=ePUVetPKu6>)

We expect intern students to support (as co-investigators / junior research associates) on one of the above. We also welcome your proposal (if your interests fall outside the above); however, several discussions may require.

Eligibility Criteria



Number of acceptances: 2 students

Requirement: CGPA \geq 3.00 (strong programming skills)

Duration: 12 weeks (19 May-11 August 2025)

Support:

- Can apply for Mahidol Student Mobility Scholarship (75,000 THB)
- Accommodation: Self-funded (50,000 Yen/month)
- Flight ticket: ~20,000 THB
- Food: ~40,000 Yen/month/person (~ 13,000 THB*3 months)
- Contact Point: Aj. Chaiyong

Past Internships at ReaLearn Lab



2023



2024

Past Internships at ReaLearn Lab



Winter 2024

Life in Sendai



Thank you!
Any Questions?